

JayDee Enterprises Inc.

3465 Lost Nation Rd. #15
Willoughby, OH 44094
PH (440) 946-9367 or (800) 989-0162
Fax (440) 946-6148
Email: sales@jdv-belts.com
Visit our website at www.jdv-belts.com

LINK-V-BELTING

Price List 1702 ~ Effective March 15, 2017

		Green DuroDrive
Belt Size	Belt Top Width	Price Per Foot
3L (3/8")	3/8"	\$8.50
A (1/2")	1/2"	\$8.85
B (5/8")	5/8"	\$10.05
C (7/8")	7/8"	\$16.10

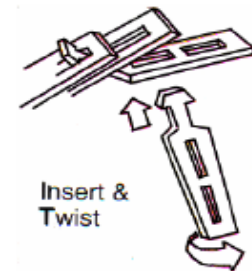

DuroDrive belts are manufactured using:

- Premium micro-milled urethanes
- Resins with ultra low VOCs
- Custom engineered fabrics in proprietary combinations
- European "reach" compliant materials
- Exclusive modular link fabrications

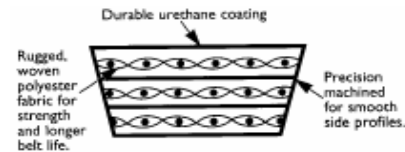

INSTALLATION IS A SNAP!!

With link belting, installation and assembly is as easy as a snap and a twist. No special tools are required to couple or uncouple each link belt. Belts can be made to accommodate any length, which makes them ideal for emergency repairs and replacements. Once assembled, link belting installs in a fraction of the time needed for endless rubber belts. Link belts install in minutes without removing outboard bearings or moving motors. *See back page for installation.*

Link belting is ideally suited as a temporary replacement or permanent substitute for conventional rubber v-belts. Horsepower ratings are the same for our link belts as they are for conventional v-belts. Composite links offer a smooth transition from sheave to sheave. Compatible with standard and SP sheaves.

Adjustable Link V-Belts

Weight	
3L - LINK	.05 LB/FT
A - LINK	.06 LB/FT
B - LINK	.09 LB/FT
C - LINK	.17 LB/FT

Price List 1702 ~ Effective March 15, 2017

Link Belting is available in lengths of 10, 25, 50, 100 or 500 foot rolls!!

INSTALLATION INSTRUCTIONS

- 1. Before installing, turn belt inside out and couple the belt.**
- 2. Place endless link belting in the nearest small sheave groove.**
- 3. Extend belt and place in the nearest large sheave groove.**
- 4. Manually turn the link belting until it is in the groove all around drive.
DO NOT jog motor!**
- 5. Continue to manually work the belt from groove to groove.**
- 6. Repeat until all grooves are filled.**

ALTERNATE INSTALLATION

- 1. Form link belt to the correct pitch length.**
- 2. Move motor forward.**
- 3. Place all belts in position.**
- 4. Move motor back into position while applying correct tension.**
- 5. Secure motor tightly.**

Belt Length Determination

Lay out pitch length of belt desired. Remove one (1) link in every 24 for A & B section or (1) link in every 20 for C-Section.

Re-tensioning:

Like all v-belts, link belts may require re-tensioning after 1-3 hours of running.

HP Capacity: Use the same rating as for standard rubber V-Belts.

HP Capacity: Use the same rating as for standard rubber v-belts.